

# AH 950

ABSOLUTE HOLLOW SHAFT ENCODER

Industry Standard Size 25  
 Syncro Flange Mounting  
 Up to 13 Bits (8192) Maximum  
 5 Volt TTL or 8 to 30 Volts  
 Gray Code or Binary Code

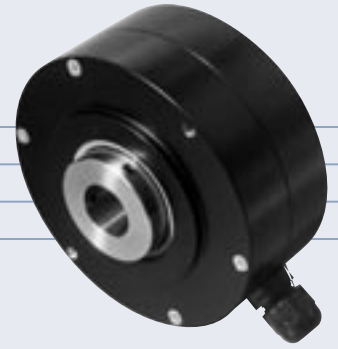

## ELECTRICAL SPECIFICATIONS

|                          |                        |
|--------------------------|------------------------|
| Supply Voltage           | 5 Volt or 8 to 30 V DC |
| Current Consumption      | 100 mA (max)           |
| Output Circuit           | Push-Pull, RS 422A     |
| Impulse Frequency        | 200 kHz (max)          |
| Logic Level (high)       | Vcc - 0.7 Volt         |
| Logic Level (low)        | 0.25 Volt (max)        |
| Short Circuit Protection | 100 %                  |

## MECHANICAL SPECIFICATIONS

|             |   |
|-------------|---|
| Cover       | Aluminium   |
| Body        | Aluminium   |
| Shaft       | Stainless Steel   |
| Speed       | 6000 RPM (max)  |
| Torque      | > 0.05 Nm   |
| Loading     | Axial 40 N, Radial 30 N                                     |
| Protection  | IP 65   |
| Temperature | -20°...+70° C (-4°...+158° F)<br>+100° C (+212° F) Optional |
| Weight      | 0.7 lb (320 g)  |

## OUTPUT SIGNALS

